

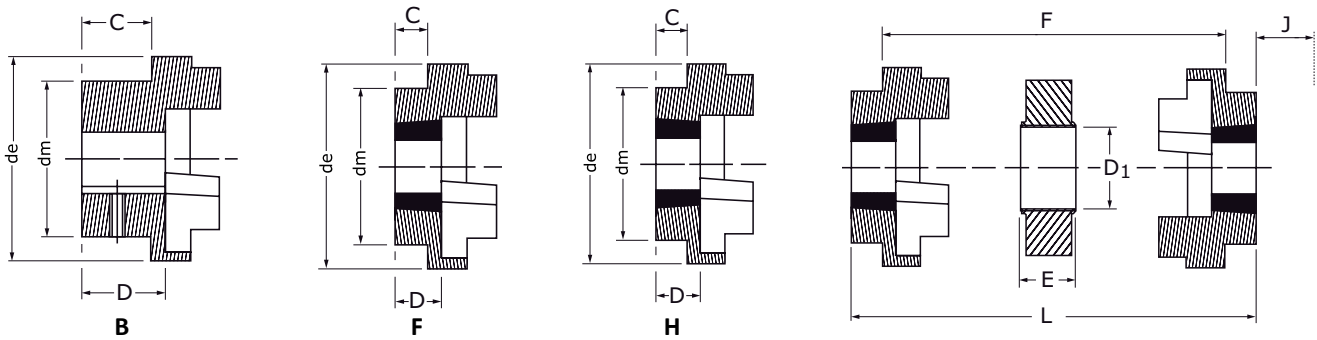
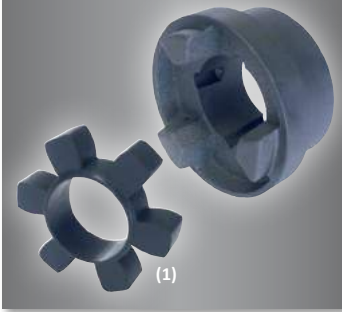

ELASTIC COUPLINGS HRC

MATERIAL : Cast iron G55

Reference	ELASTIC COUPLINGS HRC																					Max Speed (rpm)	Nominal Torque (Nm)
	Dimensions					Type F & H						Type B				Length L depending on combination							
	de	dm	D1	F	E	Bush	Bore Ø		C	D	J	C	D	Screw	Bore Ø		FF,FH,HH	FB,HB	BB				
HRC070..	69	60	31	25	18	1008	9	25	20	23,5	29	20	23,5	M6	0	32	65	65	65	9100	31,5		
HRC090..	85	70	32	30,5	22,5	1108	9	28	19,5	23,5	29	26	30	M6	0	42	69,5	76	82,5	7400	80		
HRC110..	112	100	45	45	29	1610	14	42	18,5	26,5	38	37	45	M10	0	55	82	100,5	119	5630	160		
HRC130..	130	105	50	53	36	1610	14	42	18	26,5	38	39	47,5	M10	0	60	89	110	131	4850	315		
HRC150..	150	115	62	60	40	2012	14	50	23,5	33,5	42	46	56	M10	0	70	107	129,5	152	4200	600		
HRC180..	180	125	77	73	49	2517	16	65	34,5	46,5	48	58	70	M10	0	80	142	165,5	189	3500	950		
HRC230..	225	155	99	85,5	59,5	3020	25	75	39,5	52,5	55	77	90	M12	48	100	164,5	202	239,5	2800	2000		
HRC280..	275	206	119	105,5	74,5	3525	35	90	51	66,5	67	90	105,5	M16	60	115	207,5	246,5	285,5	2300	3150		

.. Precise the combination : BB, FF, HH, BF, BH, FH

Type F bushes (taper-lock coming on the inside), H (taper-lock coming on the outside) & B (pilot bore) are interchangeable.

J : dimension needed for passage of the key for assembly and disassembly of the taper lock.

(1) Black elastomer flector with hardness 90 shore A.